

**FROST**  
DENMARK

NOVA2 CARE  
GRAB RAIL 1

Fitting instruction  
Montageanleitung  
Monteringsvejledning  
Monteringsvægledning  
Montage hanleiding  
Manuel de montage

N1964



#### Exclusion of liability

FROST accepts no liability whatsoever for damage to persons or property that occurs or has occurred as a result of improper installation or maintenance, particularly if the safety instructions and other points to note listed are not or have not been observed in full.

#### Warning and hazard notices

Improper mounting or use can lead to accidents and serious injuries.

#### GRAB RAIL 1, CURVED

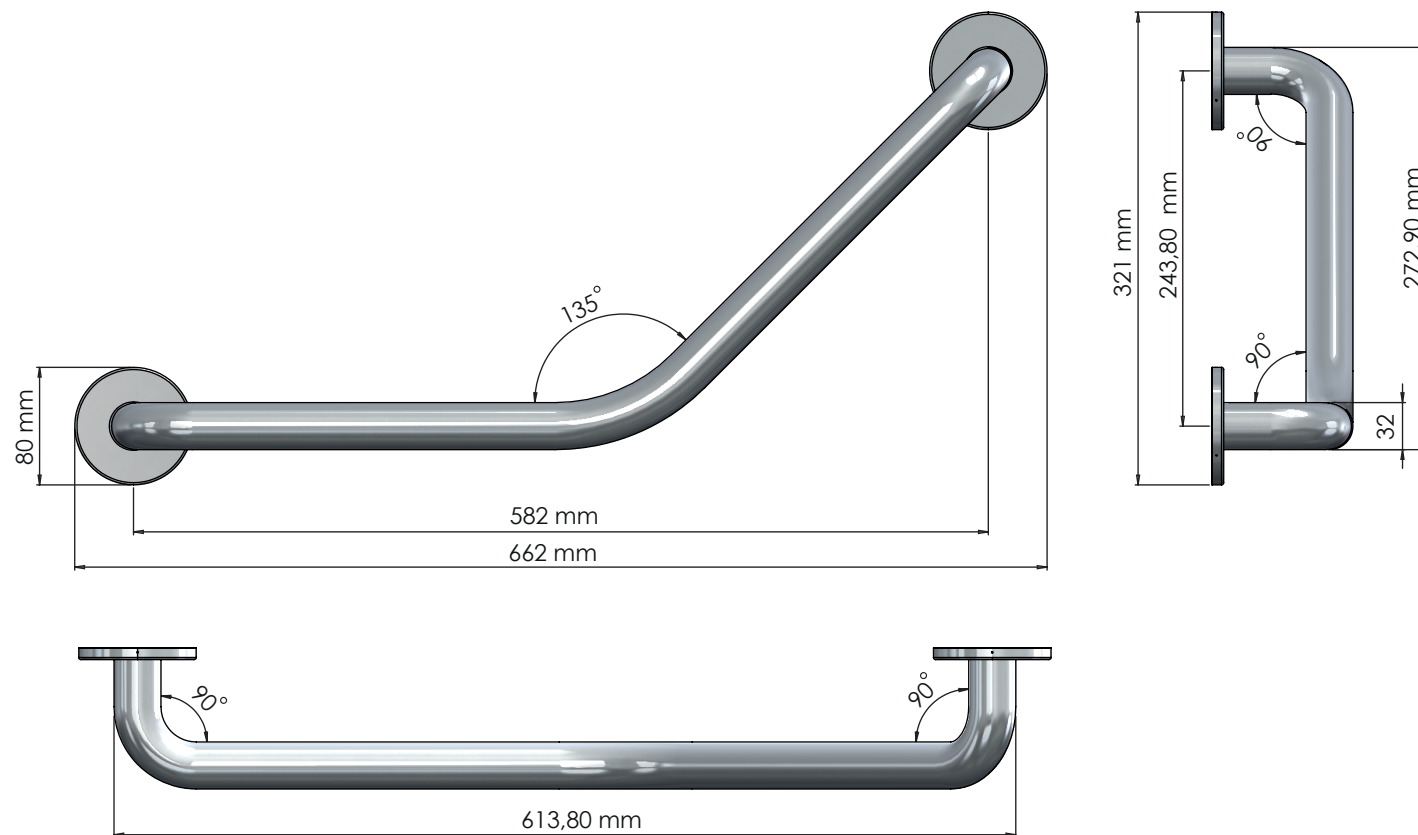

#### Cleaning and maintenance

Stainless steel surfaces should be cleaned with a microfibre cloth, glass cleaner or other non abrasive and gentle agents.

#### Attention:

Never use solvents or aggressive household cleaners like bleach, acids (e.g. descalers) or ammonia-based bathroom cleaner to clean the product. Steel wool and hard brushes can permanently damage the surface of the steel.

Before installing, the installer must ensure that the material and strength of the wall are sufficient. FROST CARE products must be mounted on a solid or reinforced wall.

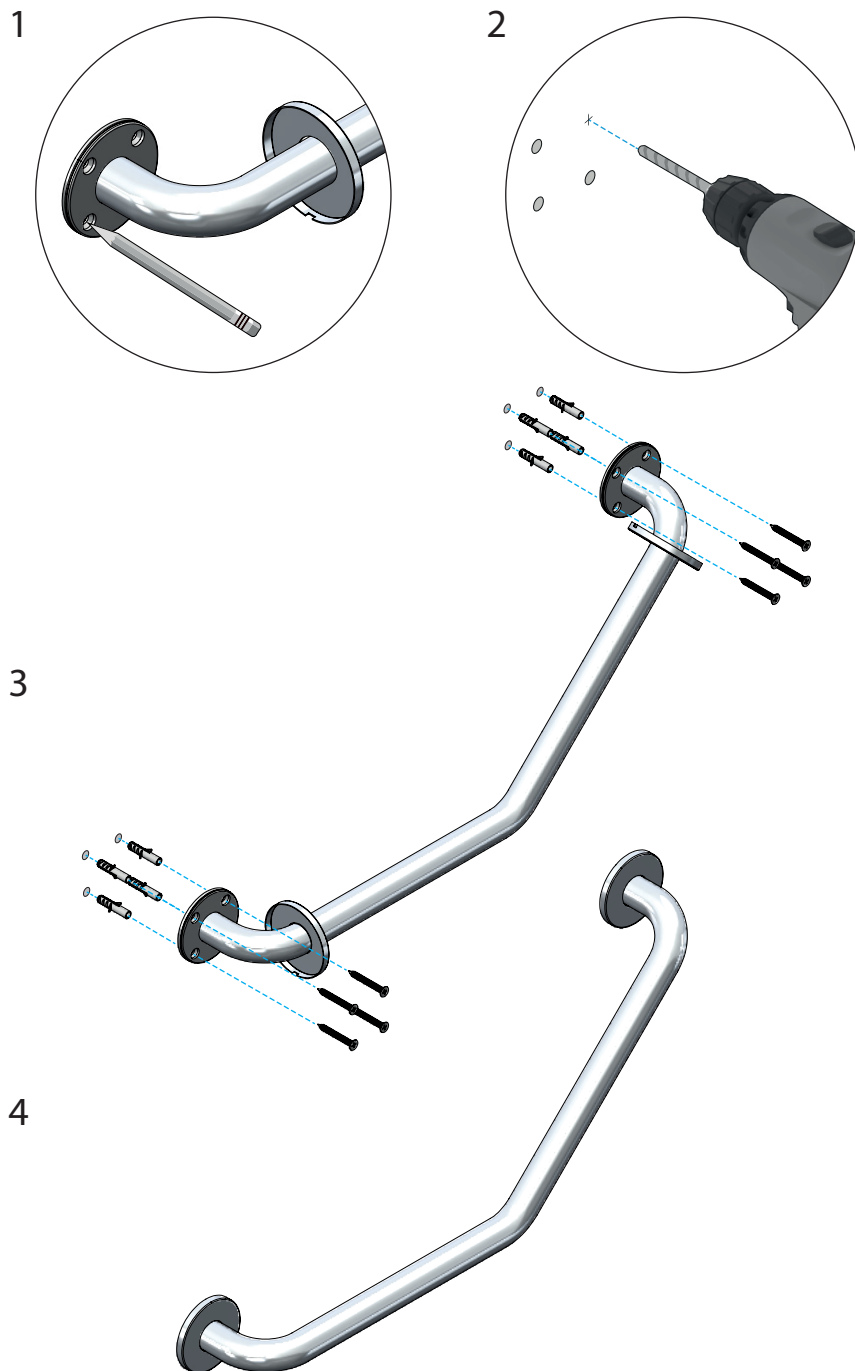

Operating  
Bedienung  
Betjening

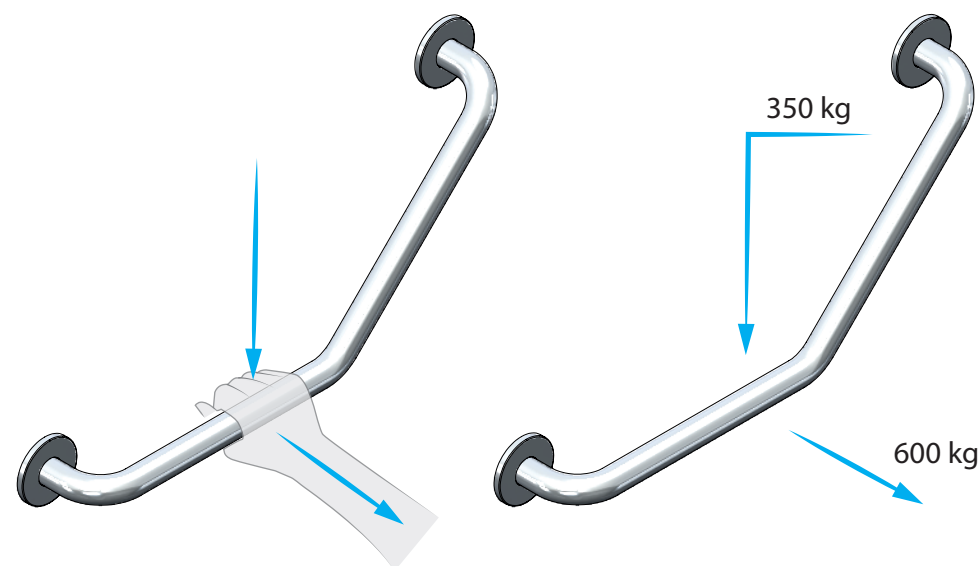

### Method of testing

To ensure that the Grab Rail is capable of withstanding heavy load and conditions every day, the product has been tested in accordance to the requirements of the European standard for technical aids for disabled, BS/EN 12182:2012.

The Grab Rail was then subjected to static load; Vertical load of 3.43 kN (350 kg) followed by a horizontal load of 5.89 kN (600 kg). After the last test, the handrail was loaded until failure at a Horizontal load of 1314 kg.

We recommend all FROST CARE products are installed on a solid wall. Reinforcement should always be used if the wall is not stable. All tests are carried out on products mounted on a solid wall, thus we cannot guarantee the same performance and durability if this is not observed.

For safety reasons, we recommend to check all bolt connections to ensure that no parts are loose and that all attachment to the wall are intact.

**FROST**  
DENMARK

Bavne Allé 32  
DK-8370 Hadsten  
+45 8761 0032  
info@frost.dk

www.frostdenmark.com

O1964



N1964



N1964-C



N1964 - BOC



N1964-GO



N1964 - BMG



N1964-B



N1964 - BCB



N1964-W



**Material:** Stainless steel, AISI 304  
**Design:** Bønnelycke mdd.  
**Manufacturer:** FROST A/S

## GRAB RAIL 1, CURVED

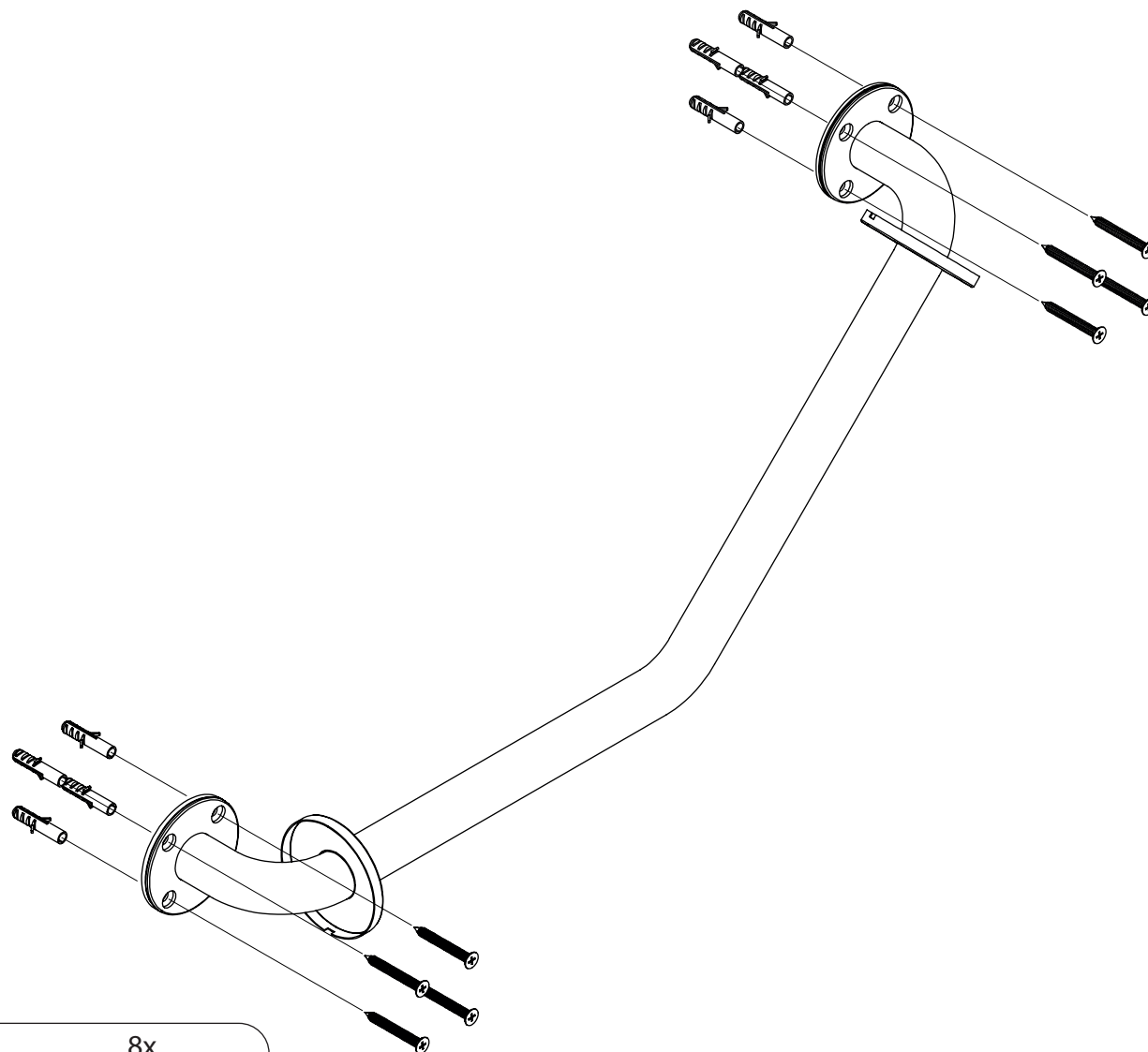

8x

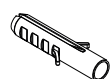

D8 - H40

(A)

8x



D10,8 - DB6 - L50

(B)