

FROST

D E N M A R K

SHOWER SET 1994

DESIGNED BY BØNNELYCKE MDD

PRODUCT DETAILS, TECHNICAL DETAILS
AND FITTING INSTRUCTIONS

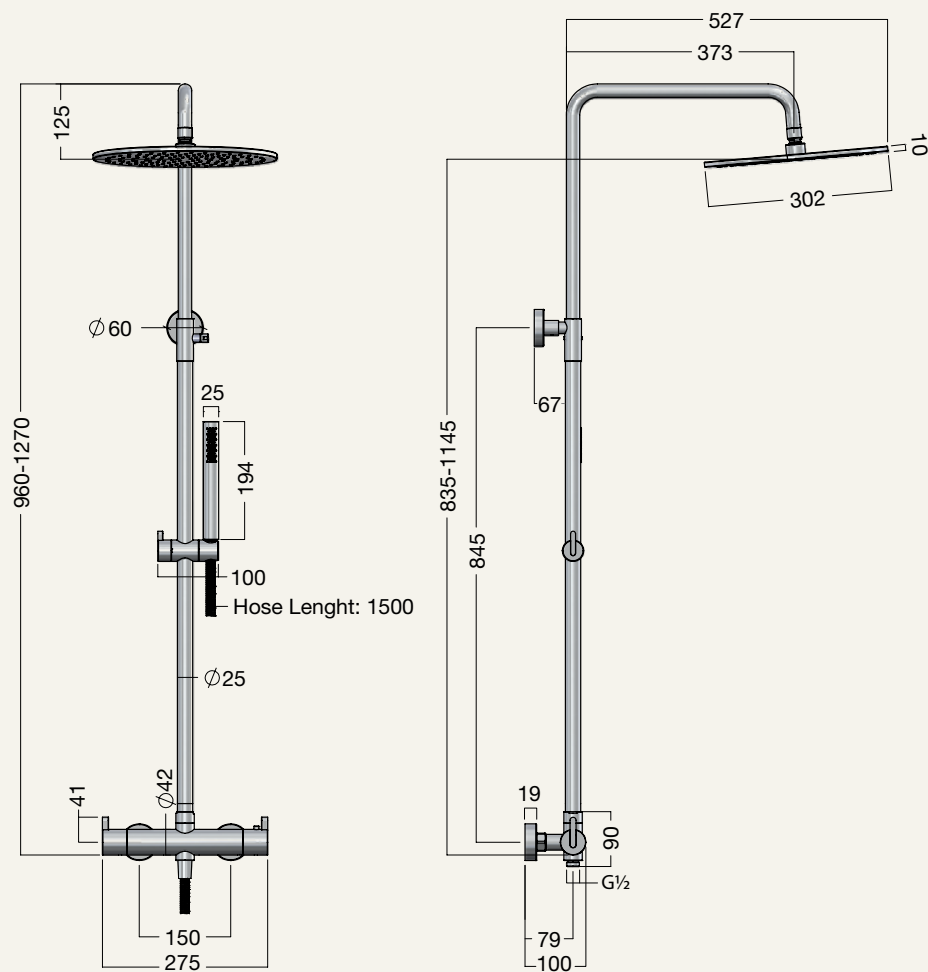

MATERIAL: STAINLESS STEEL

AVAILABLE IN THE NINE FROST FINISHES:



BEFORE MOUNTING

- 1 Before installing, make sure the hot water valve is on the left and the cold is on the right. If that's not the case, contact a professional contractor.
- 2 Turn off the water supply before installation and remove any existing unit.

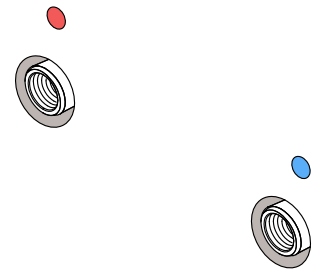

MOUNTING THE MIXER

- 3 Screw in the S-connections (A). Check their position when they protrude approximately 34 mm from the wall, the CC distance between the two S-connections must be 150 mm.
- 4 When in the right positions make markings, and then remove the connections.

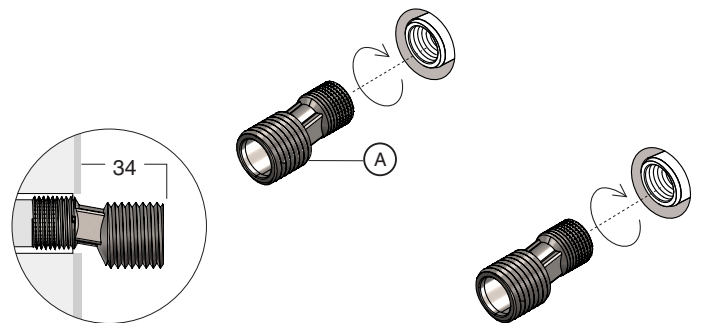

- 5 Seal them, and screw them back in with a spanner until the markings line up. Make sure not to mix up the left and right connections. Check the alignment with a spirit level.
- 6 Once the connections are fitted, fill the gap between the wall and the connections with a permanently elastic sealant.

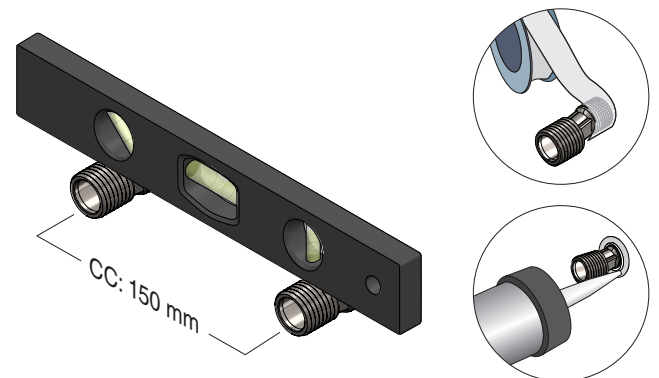

- 7 Screw the Cover Escutcheons (B) onto the S-connectors (A).
- 8 Remove the red and blue caps on the mixer and insert the two Filters (C) into the inlets of the thermostatic mixer as illustrated.
- 9 Mount the Mixer onto the connections using the two Union Nuts (D) as shown. Tighten with a spanner, but place a cloth between the spanner and the nuts to avoid damaging them.

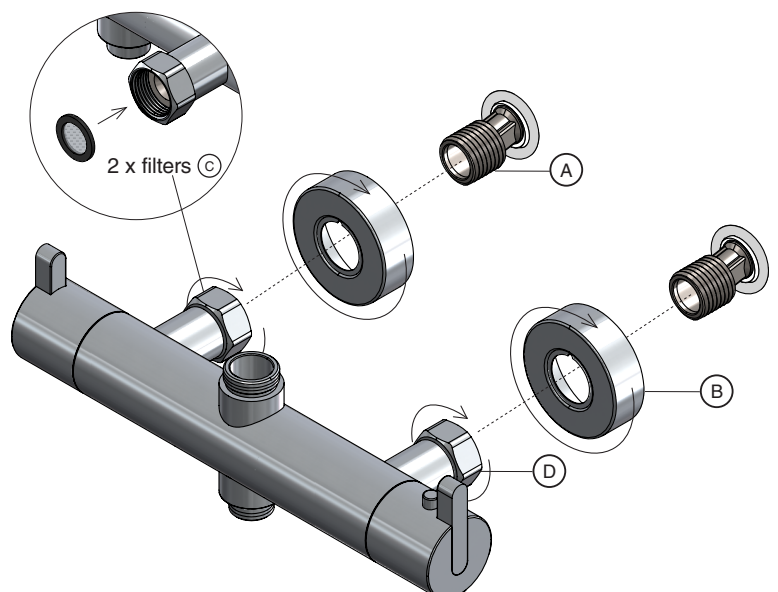

MOUNTING THE SHOWER BAR

- 10 To mount the Shower Bar (E) start by screwing it onto the mixer as illustrated. Please remember to insert the small Black Washer (F) before final mounting.

- 11 Mark the placement of the screw holes for mounting the upper Shower Bracket (G) as illustrated. Remove the Shower Bar from the Mixer again.



- 12 Drill out the marked holes with a 6 mm drill bit. Insert the enclosed Ø5x30 Wall Plugs (H). Then secure the Shower Bracket with the enclosed Ø4x39 Screws (I).

- 13 Mount the Escutcheon (J) over the Bracket.

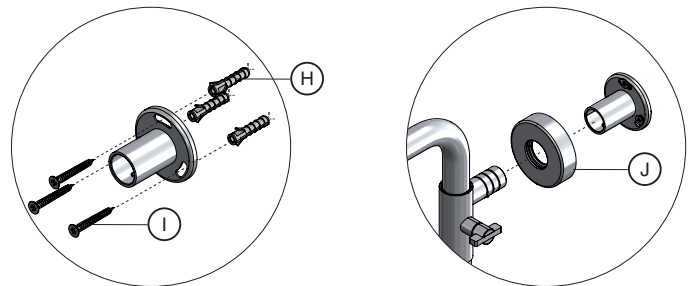

Screw the Shower Bar (E) back onto the Mixer and secure it to the Bracket (G) by using the enclosed Set Screw (K).

- 14 Securely tighten with the 2,5 mm Hex Key (L).

Check with a spirit level that everything is perfectly level.

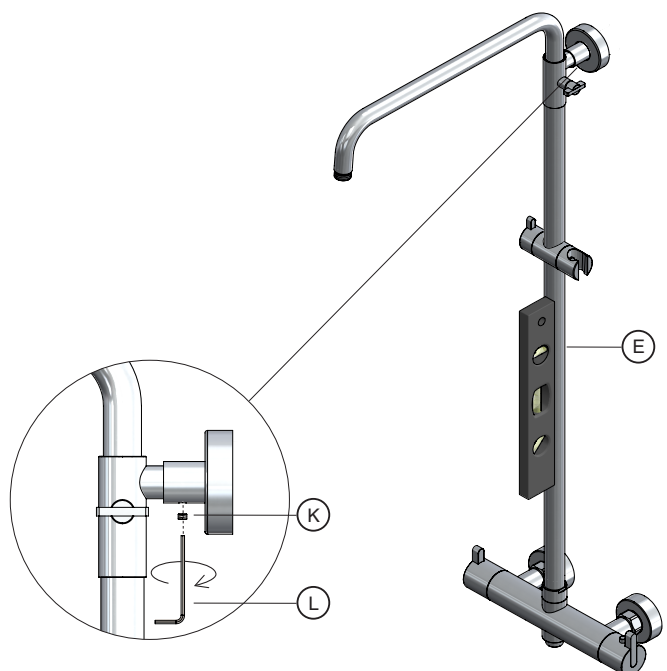

MOUNTING THE RAIN SHOWER HEAD

- 15 Mount the Rain Shower Head (M) onto the Shower Arm (O) using a spanner. Make sure the Filter (N) is inserted into the connection before mounting. Please use a cloth when tightening to avoid damaging the surface.
- ! The Shower Head has a ball-joint, allowing it to rotate into different positions according to preference.

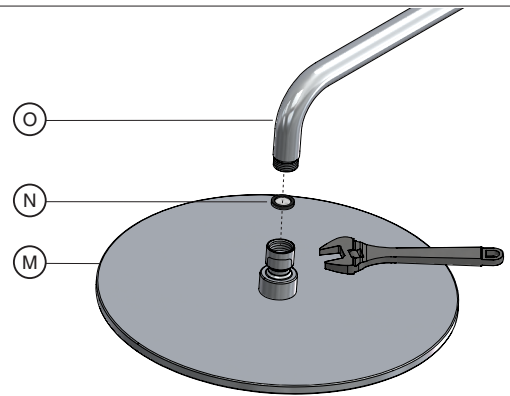

- 16 The Shower Arm (O) can be adjusted by rotating the Thumb Screw (P). Once it is at the desired height, tighten the screw again to secure the position.

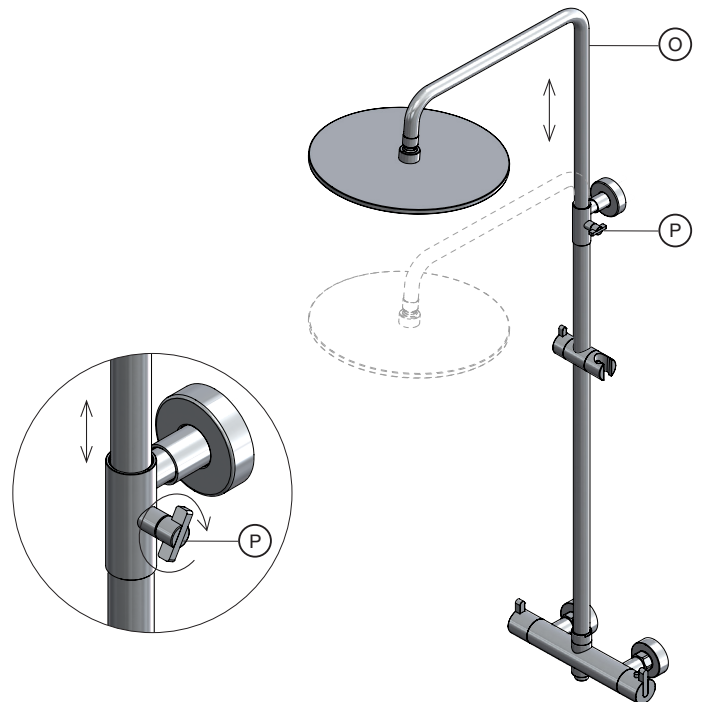

MOUNTING THE HOSE AND HANDHELD SHOWER HEAD

- 17 Connect the Shower Hose (Q) to the Thermostatic Mixer, make sure the Hose Washer (R) is inserted.
- 18 Then connect the Handheld Shower Head (S) to the Shower Hose (Q). Ensure the Hose Washer (T) is properly inserted.

The height of the Shower Head Holder can be adjusted up or down by loosening the thumb turn of the adjusting unit. The Shower Head can also be rotated into the preferred position, by turning the Holder.

If the Shower Head Holder becomes loose, you can tighten it. Simply remove the screw cover, inside the Shower Holder and tighten the screw

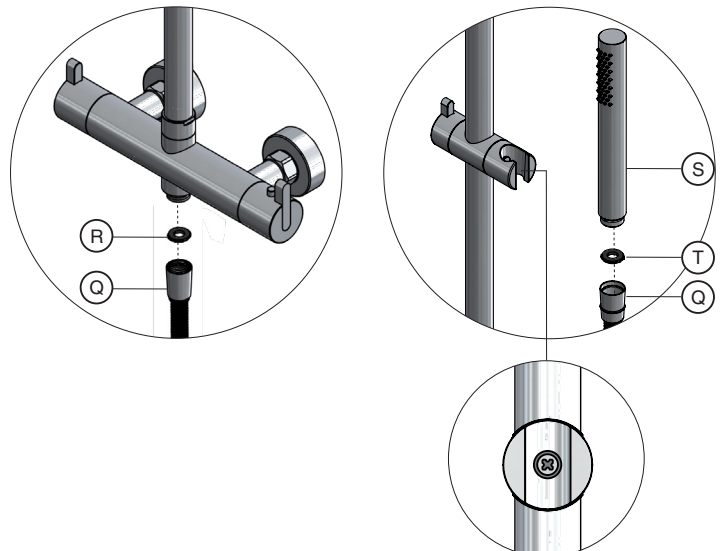

MOUNTING OF SHOWER HEAD HOLDER

The Shower Set includes an additional wall-mounted Shower Head Holder (U).

To install, first mark the screw hole positions so they are 16 mm apart (cc).
Drill holes using a 6 mm drill bit and insert the Ø6x30 mm Wall Plugs (V).

- (19) Next, fix the Brass Insert (W) in place with the Ø4x40 mm Screws (X) and tighten them using a PH2 Phillips screwdriver.
Press the Shower head Holder onto the insert and securely tighten the Set Screw (Y) underneath with the 2,5 mm Hex Key (Z).

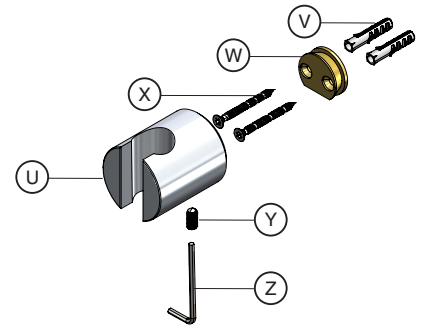

- (!) If desired, the adjustable Shower Head Holder mounted on the Shower Bar can be removed.

The Shower Set 1994 is now ready for use.

- (20) Proper care and regular cleaning will help extend the lifespan of your Shower Set. FROST also provides different spare parts for purchase to ensure long-term functionality.



HOW TO USE

- (!) To turn on the Handheld Shower Head, turn the left Handle forward.
- (!) To turn on the Rain Shower, turn the left Handle backward.
- (!) To control the cold and warm water, use the right Handle by following the markings with + and -.

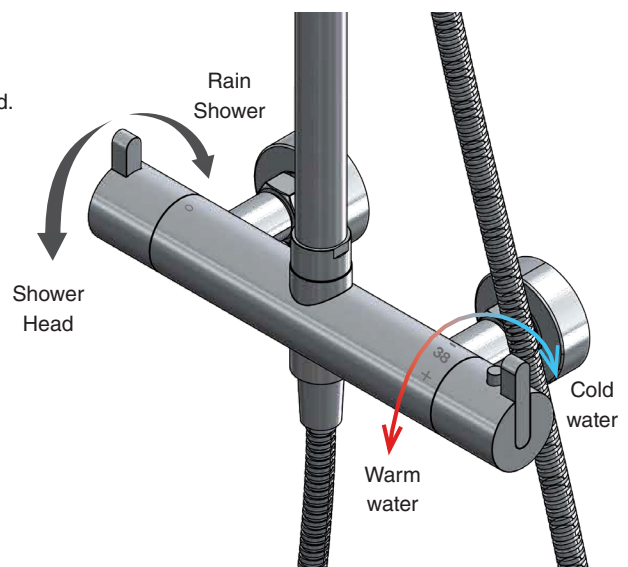

TECHNICAL INFORMATION

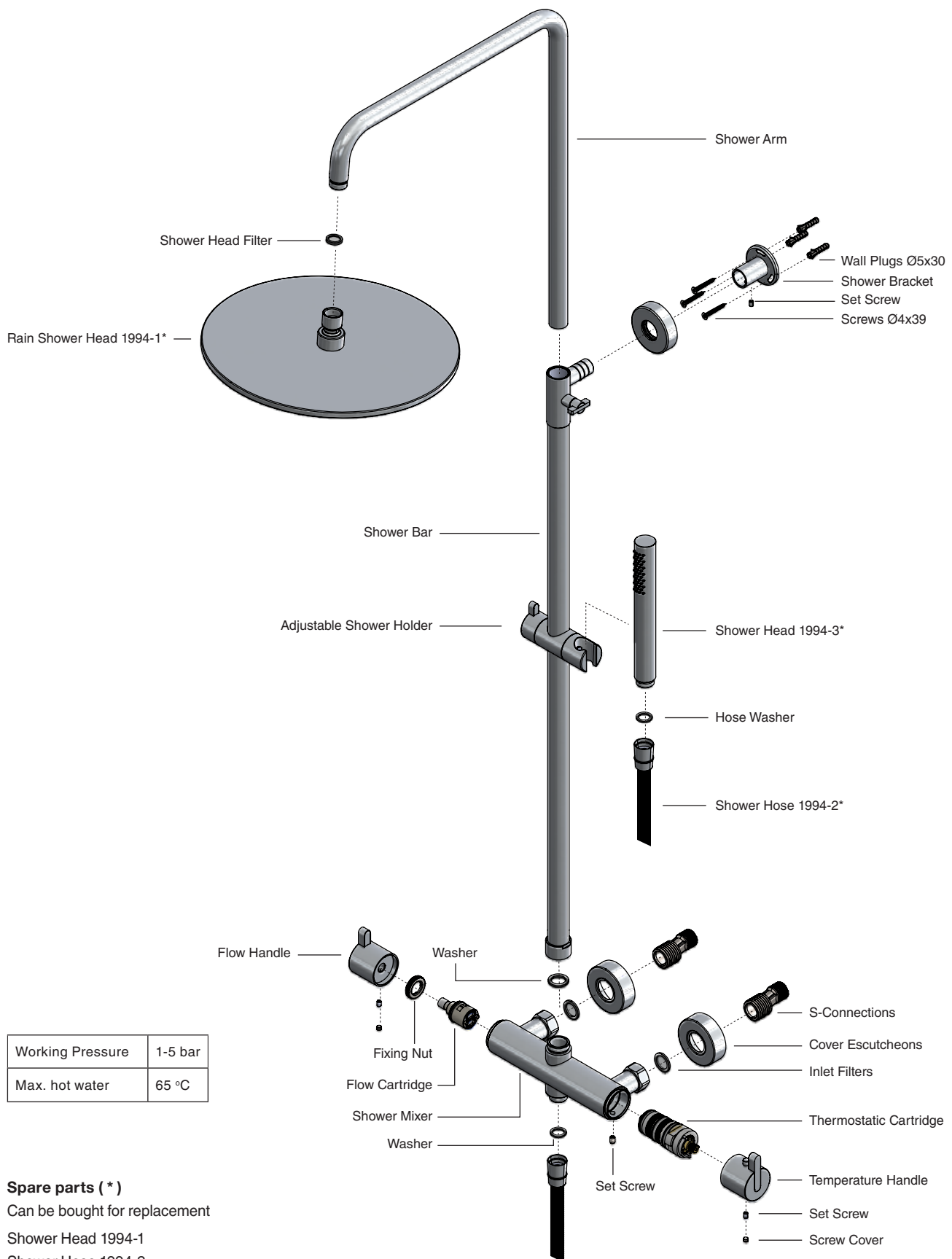

Spare parts (*)

Can be bought for replacement

Shower Head 1994-1

Shower Hose 1994-2

Shower Head 1994-3



CLEANING AND MAINTENANCE

Surfaces should be cleaned with a microfiber cloth, glass cleaner or other non abrasive and gentle agents.

ATTENTION:

Never use solvents or aggressive household cleaners like bleach, acids (e.g. descalers) or ammonia-based bathroom cleaner to clean the product. Steel wool and hard brushes can permanently damage the surface of the steel.

EXCLUSION OF LIABILITY

FROST accepts no liability whatsoever for damage to persons or property that occurs or has occurred as a result of improper installation or maintenance, particularly if the safety instructions and other points to note listed are not or have not been observed in full.

WARNING AND HAZARD NOTICES

Improper mounting or use can lead to accidents and serious injuries.

www.frostdenmark.com

Bavne Alle 32, 8370 Hadsten, Denmark

E-mail: info@frost.dk • Phone: (+45) 87 61 00 32

We are also to be found as frostdenmark on Facebook,
Instagram, Pinterest and LinkedIn

