

# FROST

D E N M A R K

## SHOWER MIXER 1996-1

DESIGNED BY BØNNELYCKE MDD

PRODUCT DETAILS, TECHNICAL DETAILS  
AND FITTING INSTRUCTIONS

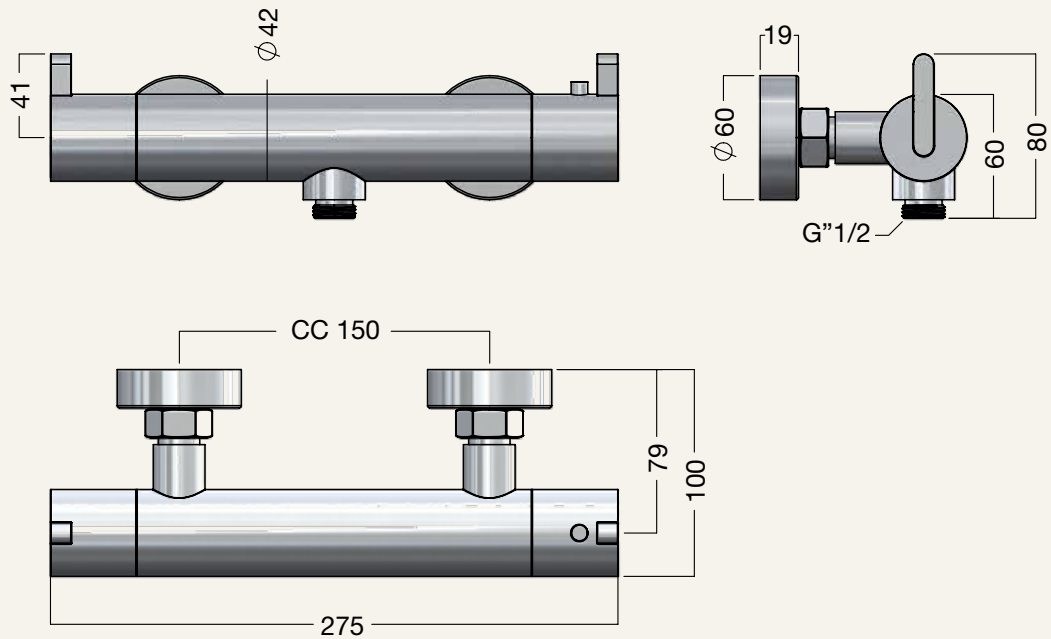

MATERIAL: STAINLESS STEEL

AVAILABLE IN THE NINE FROST FINISHES:

								
F1996-1 BRUSHED STAINLESS	F1996-1-P POLISHED STAINLESS	F1996-1-BOC BRUSHED COPPER	F1996-1-C POLISHED COPPER	F1996-1-BMG BRUSHED GOLD	F1996-1-GO POLISHED GOLD	F1996-1-BCB BRUSHED BLACK	F1996-1-B MATT BLACK	F1996-1-W MATT WHITE

## BEFORE MOUNTING

- 1 Before installing, make sure the hot water valve is on the left and the cold is on the right. If that's not the case, contact a professional contractor.
- 2 Turn off the water supply before installation and remove any existing unit.

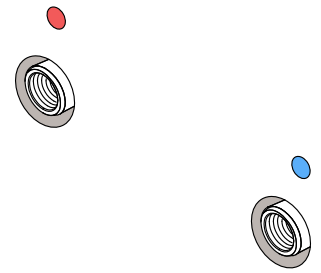

## MOUNTING THE MIXER

- 3 Screw in the S-connections (A). Check their position when they protrude approximately 34 mm from the wall, the CC distance between the two S-connections must be 150 mm.
- 4 When in the right positions make markings, and then remove the connections.

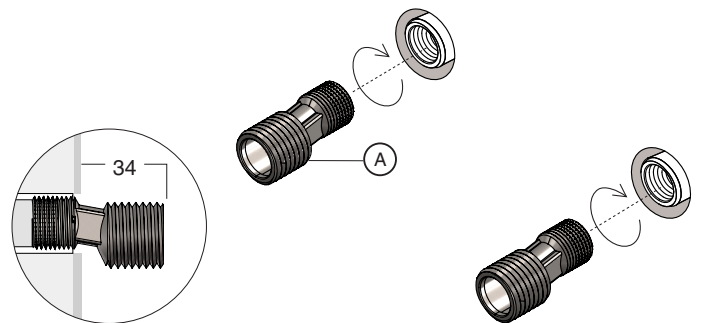

- 5 Seal them with PTFE tape, and screw them back in with a spanner until the markings line up. Make sure not to mix up the left and right connections. Check the alignment with a spirit level.
- 6 Once the connections are fitted, fill the gap between the wall and the connections with a permanently elastic sealant.

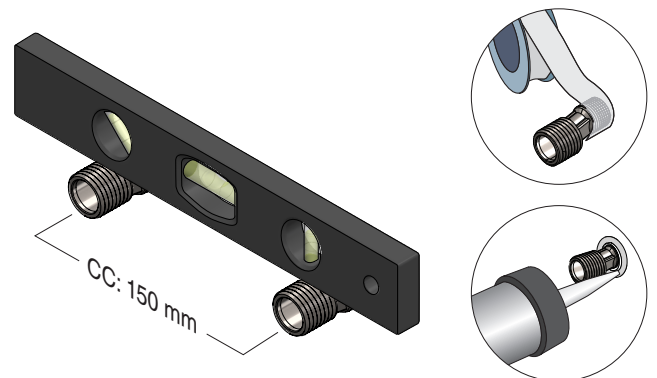

- 7 Screw the Cover Escutcheons (B) onto the S-connectors (A).
- 8 Remove the red and blue caps on the mixer and insert the two Filters (C) into the inlets of the thermostatic mixer as illustrated.
- 9 Mount the Mixer onto the connections using the two Union Nuts (D) as shown. Tighten with a spanner, but place a cloth between the spanner and the nuts to avoid damaging them.

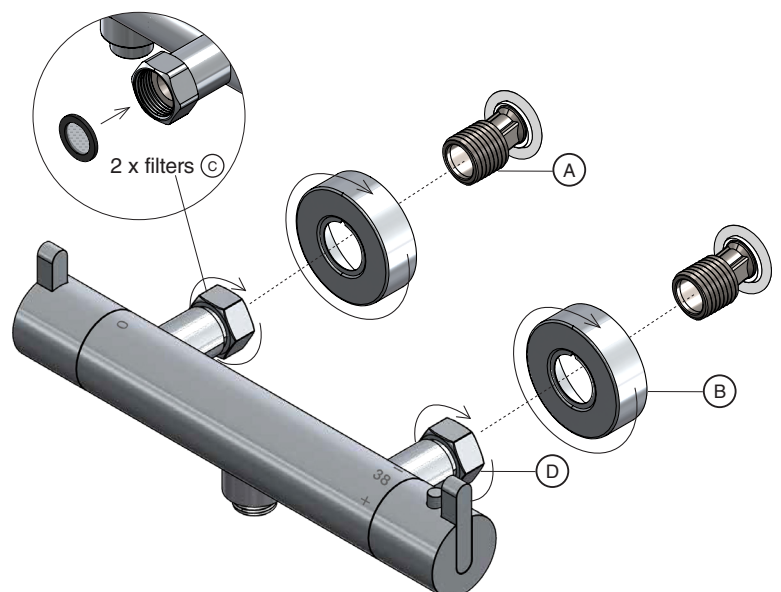

HOW TO USE

- ! To turn on the Handheld Shower Head, turn the left Handle forward.
- ! To control the cold and warm water, use the right Handle by following the markings with + and -.

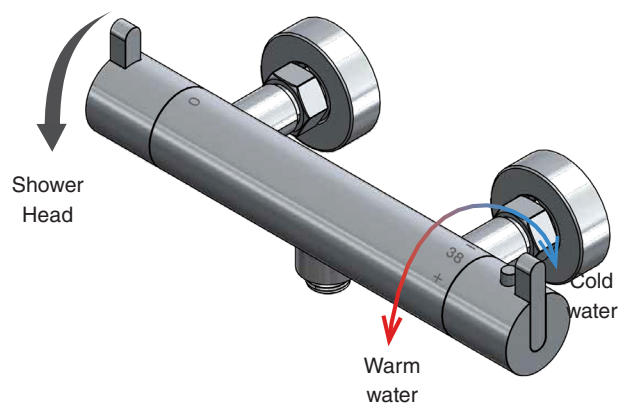

TECHNICAL INFORMATION

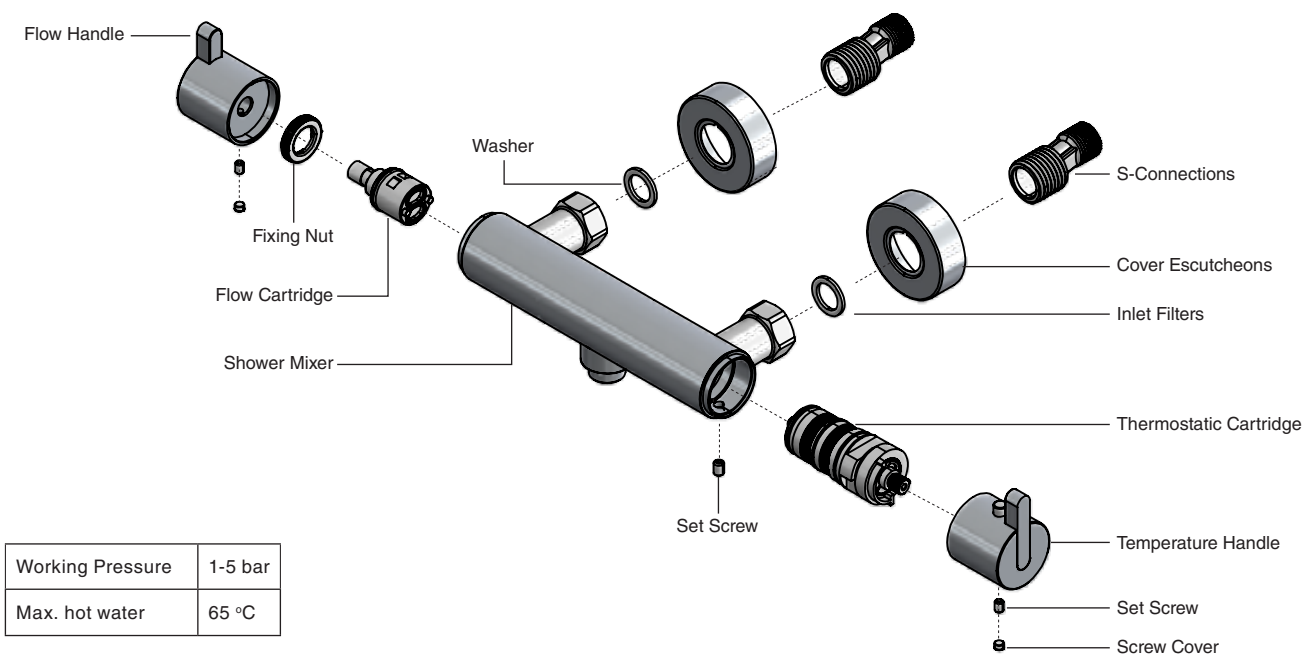

Working Pressure	1-5 bar
Max. hot water	65 °C

**Additional parts**  
Brought Separately

Shower Hose 1994-2  
Shower Head 1994-3

#### **CLEANING AND MAINTENANCE**

Surfaces should be cleaned with a microfiber cloth, glass cleaner or other non abrasive and gentle agents.

#### **ATTENTION:**

Never use solvents or aggressive household cleaners like bleach, acids (e.g. descalers) or ammonia-based bathroom cleaner to clean the product. Steel wool and hard brushes can permanently damage the surface of the steel.

#### **EXCLUSION OF LIABILITY**

FROST accepts no liability whatsoever for damage to persons or property that occurs or has occurred as a result of improper installation or maintenance, particularly if the safety instructions and other points to note listed are not or have not been observed in full.

#### **WARNING AND HAZARD NOTICES**

Improper mounting or use can lead to accidents and serious injuries.

**[www.frostdenmark.com](http://www.frostdenmark.com)**

Bavne Alle 32, 8370 Hadsten, Denmark

E-mail: [info@frost.dk](mailto:info@frost.dk) • Phone: (+45) 87 61 00 32

We are also to be found as frostdenmark on Facebook,  
Instagram, Pinterest and LinkedIn

