

**FROST**  
DENMARK

## SHOWER SLIDE BAR 1996-2

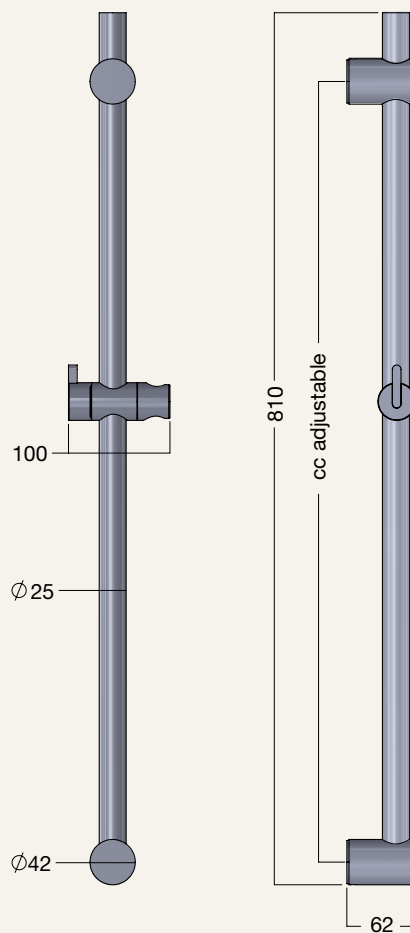







DESIGNED BY BØNNELYCKE MDD

PRODUCT DETAILS, TECHNICAL DETAILS  
AND FITTING INSTRUCTIONS



MATERIAL: STAINLESS STEEL

AVAILABLE IN THE NINE FROST FINISHES:

								
F1996-2 BRUSHED STAINLESS	F1996-2-P POLISHED STAINLESS	F1996-2-BOC BRUSHED COPPER	F1996-2-C POLISHED COPPER	F1996-2-BMG BRUSHED GOLD	F1996-2-GO POLISHED GOLD	F1996-2-BCB BRUSHED BLACK	F1996-2-B MATT BLACK	F1996-2-W MATT WHITE



## MOUNTING THE SLIDE BAR

- 1 Before installing decide the desired height of the Shower Bar (A).

Mark the position of the two brackets (B) and (C). Adjust markings to ensure that the bar will be centered over the mixer.

If you have tiles or predrilled holes from an old unit, the top bracket (B) can be adjusted by pushing it into place.

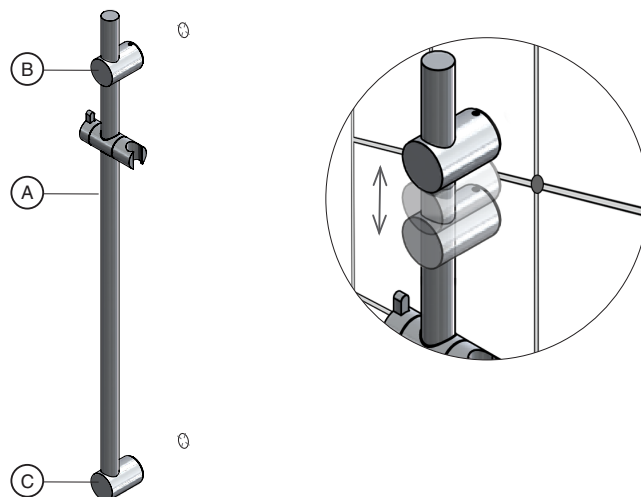

- 2 Drill the marked holes using a 5 mm drill bit and insert the enclosed Ø5x30 mm wall plugs (D).

Secure the brass inserts (E) onto the wall with the enclosed Ø6x50 mm screws (F) and use a Phillips screwdriver with bit PH2 to tighten the screws.

Press the Shower Bar onto the brass inserts and tighten the set screws (G) under both brackets with the hex key (H).

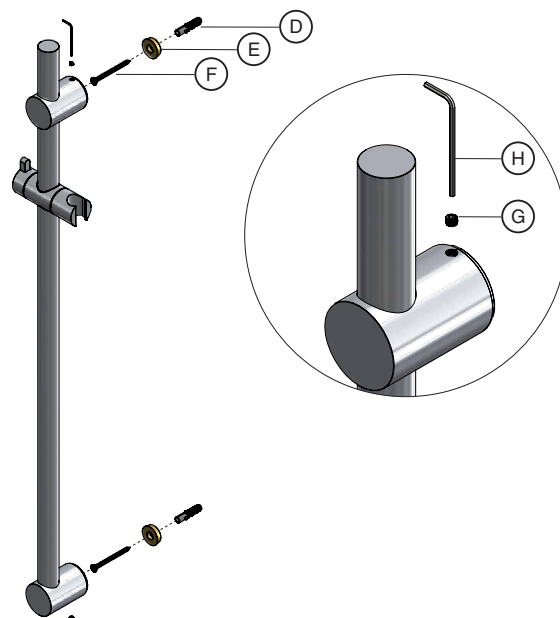

## ADJUST THE SHOWER HEAD HOLDER

- ! The height of the Shower Head can be adjusted up or down by loosening the thumb turn of the adjusting unit

- ! The Shower Head can also be rotated into the preferred position, by turning the Holder.

- ! If the Shower Holder becomes loose, you can tighten it. Simply remove the screw cover, inside the Shower Holder and tighten the screw (I).

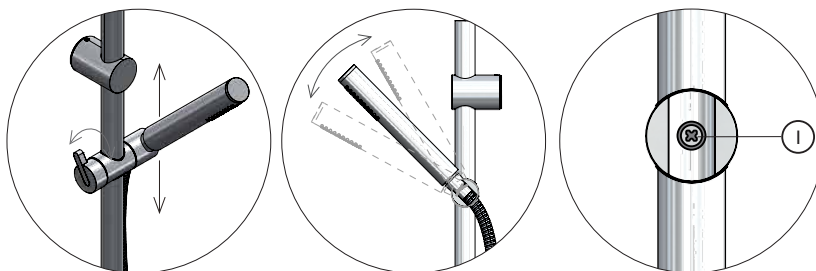

#### **CLEANING AND MAINTENANCE**

Surfaces should be cleaned with a microfiber cloth, glass cleaner or other non abrasive and gentle agents.

#### **ATTENTION:**

Never use solvents or aggressive household cleaners like bleach, acids (e.g. descalers) or ammonia-based bathroom cleaner to clean the product. Steel wool and hard brushes can permanently damage the surface of the steel.

#### **EXCLUSION OF LIABILITY**

FROST accepts no liability whatsoever for damage to persons or property that occurs or has occurred as a result of improper installation or maintenance, particularly if the safety instructions and other points to note listed are not or have not been observed in full.

#### **WARNING AND HAZARD NOTICES**

Improper mounting or use can lead to accidents and serious injuries.

**[www.frostdenmark.com](http://www.frostdenmark.com)**

Bavne Alle 32, 8370 Hadsten, Denmark

E-mail: [info@frost.dk](mailto:info@frost.dk) • Phone: (+45) 87 61 00 32

We are also to be found as frostdenmark on Facebook,  
Instagram, Pinterest and LinkedIn

