

FROST
DENMARK

HYGIENE WASTE BIN 1974-2 12 LTR

DESIGNED BY BØNNELYCKE MDD

PRODUCT DETAILS, TECHNICAL DETAILS
AND FITTING INSTRUCTIONS

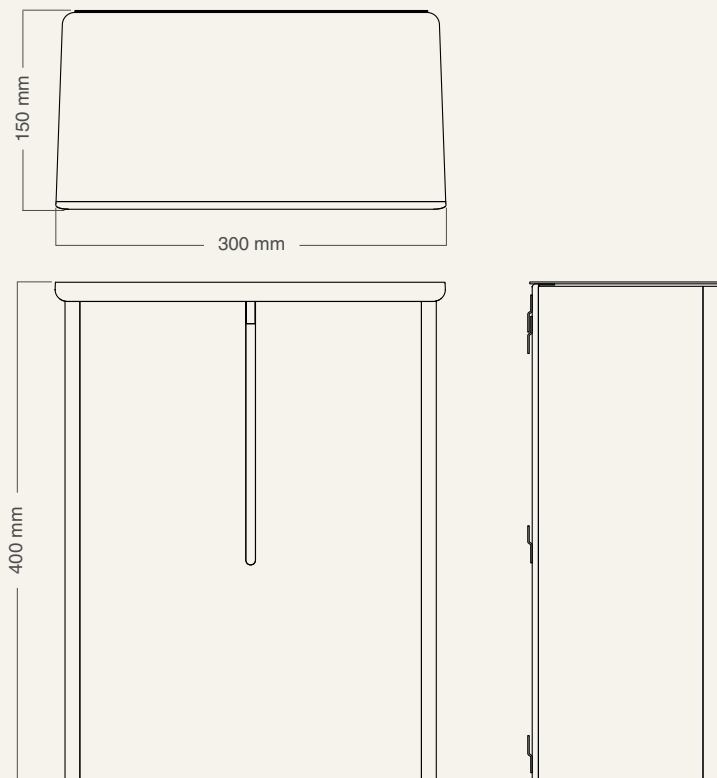

MATERIAL: STAINLESS STEEL

AVAILABLE IN THE NINE FROST FINISHES:

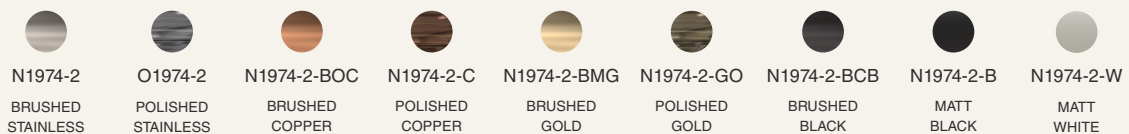

MOUNTING

- ① Mark the placement of the screw holes for mounting the Waste Bin on the wall.

Drill out the marked holes with a 6 mm drill bit and insert the enclosed Ø6x30 mm wall plugs (A).

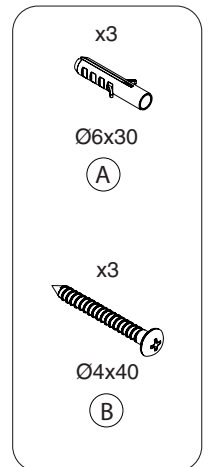
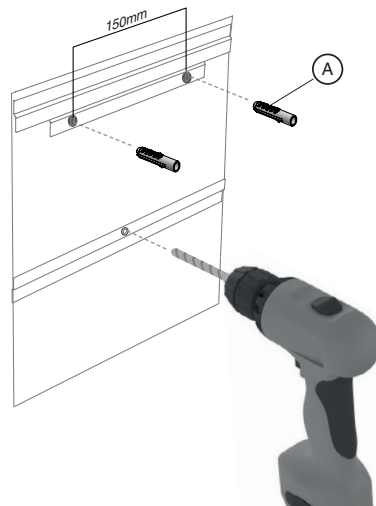

- ② Secure the loose bracket to the wall with the enclosed Ø4x40 mm screws (B) and use a Phillips screwdriver with bit PH2 to tighten the screws.

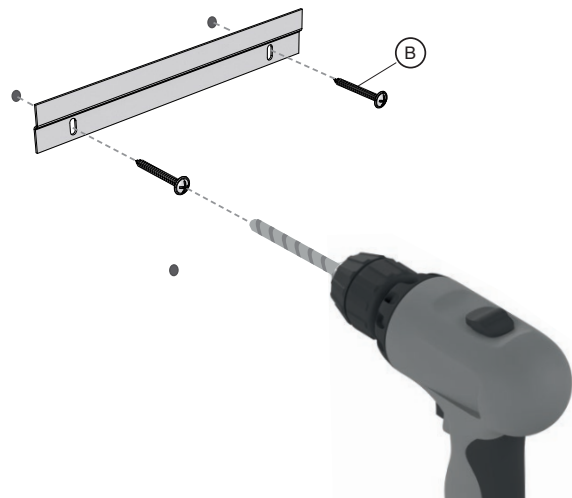

- ③ Place the Waste Bin shell onto the mounted bracket.
- Ensure the bottom hole aligns with the screw hole on the build-on bracket system.

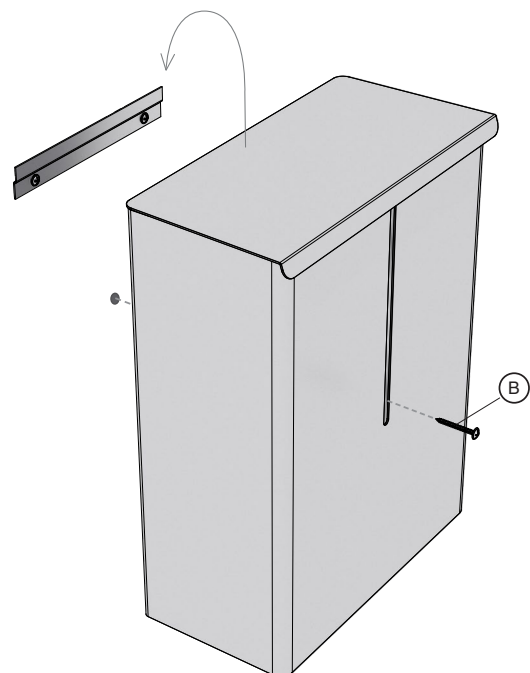

-
- ④ Using a long screwdriver, insert and tighten the remaining Ø4x40 mm screw through the last hole to secure the bin.

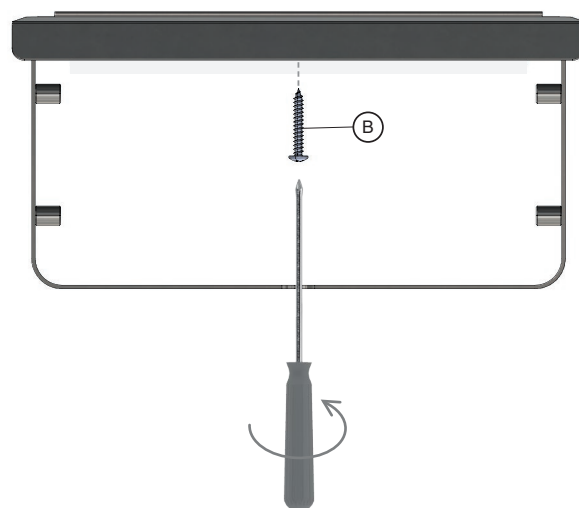

-
- ⑤ Place a plastic bag inside the bin container and insert it into the Waste Bin shell. Your Hygiene Waste Bin is now ready for use.

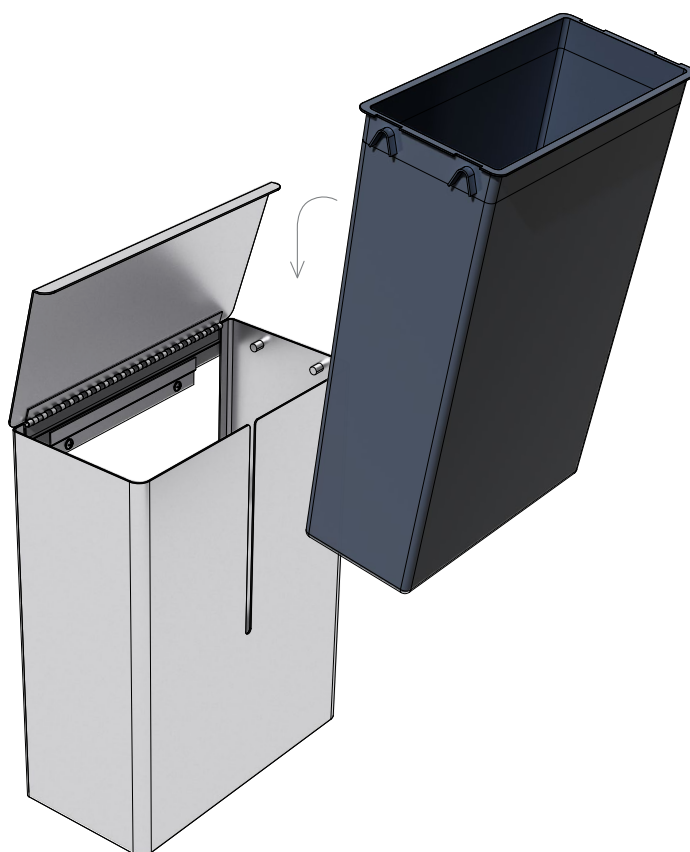

CLEANING AND MAINTENANCE

Surfaces should be cleaned with a microfiber cloth, glass cleaner or other non abrasive and gentle agents.

ATTENTION:

Never use solvents or aggressive household cleaners like bleach, acids (e.g. descalers) or ammonia-based bathroom cleaner to clean the product. Steel wool and hard brushes can permanently damage the surface of the steel.

EXCLUSION OF LIABILITY

FROST accepts no liability whatsoever for damage to persons or property that occurs or has occurred as a result of improper installation or maintenance, particularly if the safety instructions and other points to note listed are not or have not been observed in full.

WARNING AND HAZARD NOTICES

Improper mounting or use can lead to accidents and serious injuries.

www.frostdenmark.com

Bavne Alle 32, 8370 Hadsten, Denmark

E-mail: info@frost.dk • Phone: (+45) 87 61 00 32

We are also to be found as frostdenmark on Facebook,
Instagram, Pinterest and LinkedIn

